

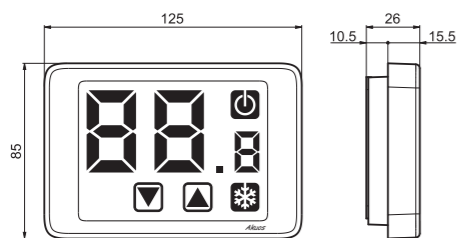

2 DIMENSIONS

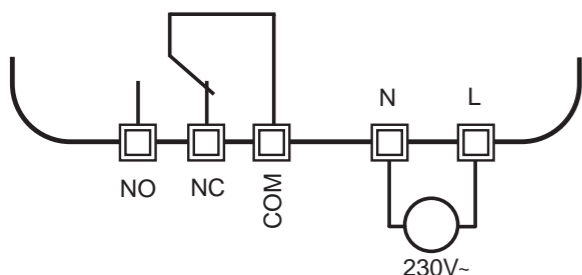

3 WIRING DIAGRAMS



4 LEGEND

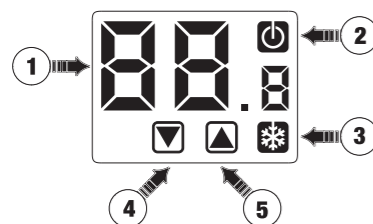

- ① "Environment humidity" Field
- ② "Off" Field
- ③ "Load activation" Field
- ④ Key "▼" decreases the selected field
- ⑤ Key "▲" increases the selected field

Attention: the keys are active only if the instrument is installed on wall-mounted base.

5 INSTALLATION

- Akuos series humidistats are designed for wall mounting installation. Alternatively, they can be installed to cover the three-module in built box.
- Install the humidistat at a height of about 1.5 m above the floor, away from direct sunlight, away from doors, windows, heat sources, locations with excess or total lack of ventilation.

① Connect the wires to the terminal block on back of the base, as shown in the "wiring diagrams".

② Fix the base on the wall using the screws supplied.

③ Attach the humidistat to the base, at first mating teeth on the higher side.

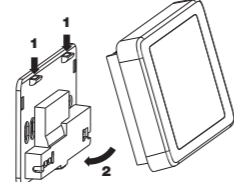
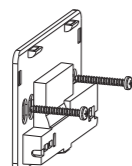
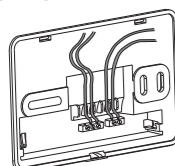

1 User Manual

ELECTRONIC TOUCH SCREEN HUMIDISTATS

⚠ Read all instructions carefully

Serie di wall mounting touch screen humidistats for humidity control which perform actions of type 1B and are intended for operating in environments Pollution Degree 2 and Overvoltage Category III (EN60730-1).

| Code | Model | Description |
|----------|--------------|---|
| VE476800 | Akuos Bianco | Touch screen humidistat 230V white colour |
| VE477600 | Akuos Nero | Touch screen humidistat 230V black colour |

SAFETY WARNINGS

During product installation and operation it is necessary to observe the following instructions:

- 1) The instrument must be installed by a qualified person, in strict compliance with the connection diagrams.
- 2) Do not power or connect the instrument if any part of it is damaged.
- 3) After installation, inaccessibility to the connection terminals without appropriate tools must be guaranteed.
- 4) The instrument must be installed and activated in compliance with current electric systems standards.
- 5) Before accessing the connection terminals, verify that the leads are not live.
- 6) In the electrical system of the building where the instrument must be installed, a switch and a protection device from the overcurrents must be present.

TECHNICAL SPECIFICATIONS

- Power supply:
 - 230Vac (-15% ÷ +10%) 50/60Hz
 - max absorption: 6 VA / 230Vac
- Wall mounting (or to coverage three-module in built box)
- Terminals:
 - 3 terminals for 1.5 mm² cable section for monostable output relay 5A / 250Vac
 - 2 terminals for 1.5 mm² cable section for power supply
- Regulation type:
 - on/off with settable differential fixed ± 2.5% RH
- Measurement precision: ± 5% RH
- Measurement humidity resolution: 1% RH
- Settable setpoint range: 30% ÷ 90% RH
- Password protected lock keypad
- Operating temperature: 0 °C ÷ +50 °C
- Storage temperature: -10 °C ÷ +65 °C
- Operating humidity: 20÷90% non-condensing
- Degree of protection: IP40
- Insulation: reinforced among accessible parts (frontal) and all other terminals

6 OPERATION

During the standard operation the humidistat displays the detected humidity value and the relay status is identified by the symbol switching on.

Setpoint modification

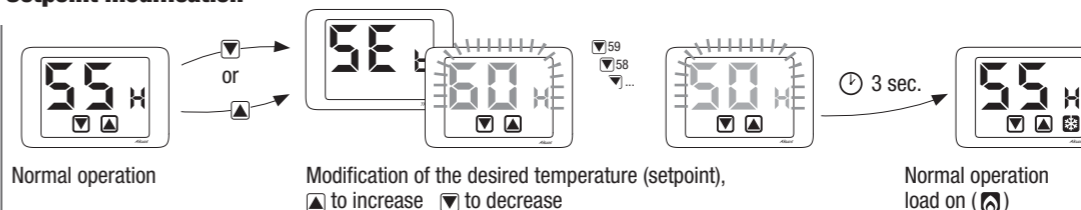

Switch off

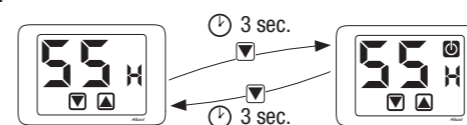

Note: In OFF mode it's not possible to access the setpoint modification.

Error messages

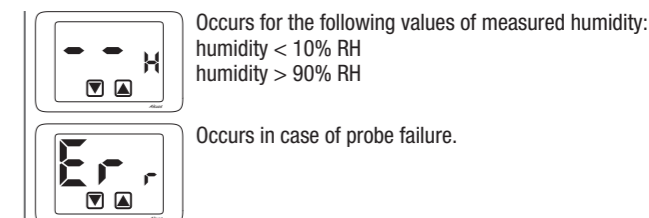

Advanced programming

Through the advanced programming menu it is possible to limit below and above the range of values that can be set as setpoint. It is also possible to set a password to lock the keypad to prevent changes by unauthorized persons. To enter menu Advanced programming keep simultaneously pressed for 3 seconds the keys ▲ and ▼ until Pr will appear. The items of the menu are displayed in succession. For each item is displayed an identity breviation and its relative blinking value. Use the keys ▲ and ▼ to modify the blinking value. After 3 seconds without touching the keys there is the passage to the following parameter. The writing End will appear when all parameters are set and the humidistat returns successively in standard mode saving the effected modifications.

Minimum settable setpoint - L0
It's the minimum value settable as setpoint.
Settable values: 30% ÷ 90% RH

Maximum settable setpoint - H1
It's the maximum value settable as setpoint.
Settable values: L0 ÷ 90% RH

Password for keypad lock - PR5
Set a value between 001 and 999 to activate the keypad lock. Set "---" to disable the lock. If the keypad lock is active, pressing one key during normal operation LoC appears and the password is required. If it's properly inserted the keyboard is unlocked and stays until 30 seconds after the last press of a key.

Backlighting management

During normal operation the display is on and backlit with blue light. If not desired the backlighting function can be disabled (for example in bedrooms). Then the humidistat continues its standard operation and the backlight is enabled entering menu: setpoint modification, advanced programming, pin enter.

Reset

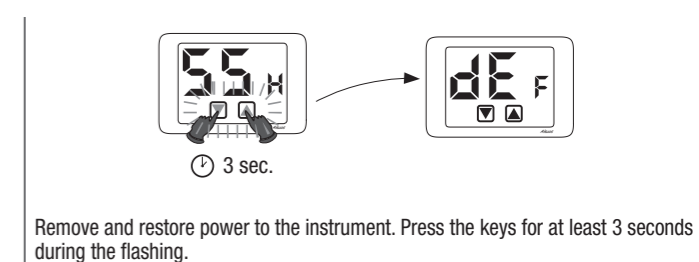

Default values

| | |
|--------------------------------|----------------|
| Setpoint | 50% RH |
| Minimum settable setpoint - L0 | 30% RH |
| Maximum settable setpoint - H1 | 90% RH |
| Password | --- (disabled) |

REFERENCE STANDARDS

Compliance with Community Directives:
2006/95/EC (Low voltage)
2004/108/EC (E.M.C.)
is declared in reference to the harmonized standard:
• EN 60730-2-13