

TECHNICAL CHARACTERISTICS

Series of insulators designed to be used as supports or spacers of electrically active parts such as the bars used to create panels.

Made of polyester resin with the addition of glass fibres, they guarantee a high mechanical and electrical resistance over time. Furthermore, the material is non absorbing and highly self-extinguishing.

On both resting sides the insulators feature a brass or white iron zincate threaded female insert that, by means of different types of special headless screws, allows the coupling with the parts concerned, while the lower part features a hexagonal band for the fastening.

- Colour: red RAL-3002 (a different colour can be provided on request in case of large orders)
- Arc resistance: > 180 s - ASTM D-495
- Material: self-extinguishing in class V0 (1.6 mm) according to the UL-94 standard
- Operating temperature: $-40\text{ }^{\circ}\text{C} \div +130\text{ }^{\circ}\text{C}$
- Water absorption: < 0.2% - ASTM D-570
- Tracking resistance: 3 W/min - ASTM D-2302
- For the fastening please refer to the section "GV series accessories"



DIMENSIONS (mm)

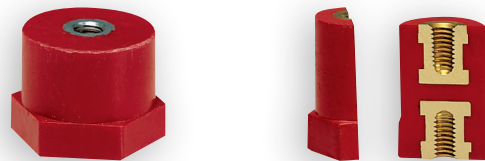
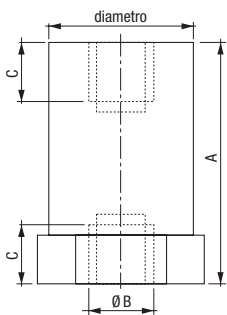

Spacer column insulators SELECTABLE ELEMENTS

CP SERIES

| | Code | Model | Diameter (mm) | Tensile strength (daN) | Flexural strength (daN) | Max rated voltage at 50Hz for 1 min (kV) | Min internal flashover voltage AC (kV) | Operating voltage DC / AC (V) | Height (mm) | |
|------------------|----------|-----------|---------------|------------------------|-------------------------|--|--|-------------------------------|-------------|-----|
| | | | | | | | | | (A) | (C) |
| M4 insert | | | | | | | | | | |
| | SA580800 | CP2016-04 | 20 | 400 | 250 | 3 | 10 | 400 | 16 | 5 |
| | SA584000 | CP2020-04 | 20 | 400 | 250 | 3.5 | 10 | 600 | 20 | 5 |
| | SA589900 | CP2025-04 | 20 | 400 | 200 | 5 | 15 | 600 | 25 | 5 |
| M5 insert | | | | | | | | | | |
| | SA581600 | CP2016-05 | 20 | 400 | 250 | 3 | 10 | 400 | 16 | 5 |
| | SA585700 | CP2020-05 | 20 | 400 | 250 | 3.5 | 10 | 600 | 20 | 5 |
| | SA590700 | CP2025-05 | 20 | 400 | 200 | 5 | 15 | 600 | 25 | 5 |
| | SA594900 | CP2030-05 | 20 | 400 | 200 | 5 | 15 | 600 | 30 | 9 |
| | SA597200 | CP2035-05 | 20 | 400 | 150 | 8 | 25 | 600 | 35 | 9 |
| | SA600400 | CP2040-05 | 20 | 400 | 150 | 8 | 25 | 600 | 40 | 9 |
| | SA603800 | CP2045-05 | 20 | 400 | 100 | 8 | 25 | 600 | 45 | 9 |
| | SA606100 | CP2050-05 | 20 | 400 | 100 | 10 | 30 | 750 | 50 | 9 |
| M6 insert | | | | | | | | | | |
| | SA582400 | CP2016-06 | 20 | 400 | 250 | 3 | 10 | 400 | 16 | 5 |
| | SA587300 | CP2020-06 | 20 | 400 | 250 | 3.5 | 10 | 600 | 20 | 5 |
| | SA591500 | CP2025-06 | 20 | 400 | 200 | 5 | 15 | 600 | 25 | 5 |
| | SA595600 | CP2030-06 | 20 | 400 | 200 | 5 | 15 | 600 | 30 | 10 |
| | SA598000 | CP2035-06 | 20 | 400 | 150 | 8 | 25 | 600 | 35 | 10 |
| | SA601200 | CP2040-06 | 20 | 400 | 150 | 8 | 25 | 600 | 40 | 10 |
| | SA604600 | CP2045-06 | 20 | 400 | 100 | 8 | 25 | 600 | 45 | 10 |
| | SA607900 | CP2050-06 | 20 | 400 | 100 | 10 | 30 | 750 | 50 | 10 |
| | SA609500 | CP3030-06 | 30 | 900 | 450 | 8 | 25 | 750 | 30 | 10 |
| | SA611100 | CP3035-06 | 30 | 900 | 450 | 8 | 25 | 750 | 35 | 10 |
| | SA613700 | CP3040-06 | 30 | 900 | 300 | 10 | 30 | 1000 | 40 | 10 |
| | SA615200 | CP3045-06 | 30 | 900 | 300 | 10 | 30 | 1000 | 45 | 10 |
| | SA617800 | CP3050-06 | 30 | 900 | 200 | 10 | 40 | 1500 | 50 | 15 |
| | SA619400 | CP3055-06 | 30 | 900 | 200 | 10 | 40 | 1500 | 55 | 15 |
| | SA621000 | CP3060-06 | 30 | 900 | 150 | 15 | 40 | 1500 | 60 | 15 |
| | SA623600 | CP3065-06 | 30 | 900 | 150 | 15 | 40 | 1500 | 65 | 15 |
| | SA625100 | CP3070-06 | 30 | 900 | 150 | 15 | 40 | 1500 | 70 | 15 |

Ultimate strength tolerance $\pm 10\%$ 1 daN = 10 N

| | Code | Model | Diameter (mm) | Tensile strength (daN) | Flexural strength (daN) | Max rated voltage at 50Hz for 1 min (kV) | Min internal flashover voltage AC (kV) | Operating voltage DC / AC (V) | Height (mm) | |
|-------------------|----------|-----------|---------------|------------------------|-------------------------|--|--|-------------------------------|-------------|-----|
| | | | | | | | | | (A) | (C) |
| M8 insert | | | | | | | | | | |
| | SA583200 | CP2016-08 | 20 | 400 | 250 | 3 | 10 | 400 | 16 | 5 |
| | SA588100 | CP2020-08 | 20 | 400 | 250 | 3.5 | 10 | 600 | 20 | 5 |
| | SA592300 | CP2025-08 | 20 | 400 | 200 | 5 | 15 | 600 | 25 | 5 |
| | SA596400 | CP2030-08 | 20 | 400 | 200 | 5 | 15 | 600 | 30 | 10 |
| | SA599800 | CP2035-08 | 20 | 400 | 150 | 8 | 25 | 600 | 35 | 10 |
| | SA602000 | CP2040-08 | 20 | 400 | 150 | 8 | 25 | 600 | 40 | 10 |
| | SA605300 | CP2045-08 | 20 | 400 | 100 | 8 | 25 | 600 | 45 | 10 |
| | SA608700 | CP2050-08 | 20 | 400 | 100 | 10 | 30 | 750 | 50 | 10 |
| | SA610300 | CP3030-08 | 30 | 900 | 450 | 8 | 25 | 750 | 30 | 10 |
| | SA612900 | CP3035-08 | 30 | 900 | 450 | 8 | 25 | 750 | 35 | 10 |
| | SA614500 | CP3040-08 | 30 | 900 | 300 | 10 | 30 | 1000 | 40 | 10 |
| | SA616000 | CP3045-08 | 30 | 900 | 300 | 10 | 30 | 1000 | 45 | 15 |
| | SA618600 | CP3050-08 | 30 | 900 | 200 | 10 | 40 | 1500 | 50 | 15 |
| | SA620200 | CP3055-08 | 30 | 900 | 200 | 10 | 40 | 1500 | 55 | 15 |
| | SA622800 | CP3060-08 | 30 | 900 | 150 | 15 | 40 | 1500 | 60 | 15 |
| | SA624400 | CP3065-08 | 30 | 900 | 150 | 15 | 40 | 1500 | 65 | 15 |
| | SA626900 | CP3070-08 | 30 | 900 | 150 | 15 | 40 | 1500 | 70 | 15 |
| | SA627700 | CP4030-08 | 40 | 1000 | 700 | 8 | 25 | 750 | 30 | 10 |
| | SA629300 | CP4035-08 | 40 | 1000 | 700 | 8 | 25 | 750 | 35 | 10 |
| | SA631900 | CP4040-08 | 40 | 1000 | 500 | 10 | 30 | 1000 | 40 | 10 |
| | SA634300 | CP4045-08 | 40 | 1000 | 500 | 10 | 30 | 1000 | 45 | 15 |
| | SA637600 | CP4050-08 | 40 | 1000 | 500 | 10 | 40 | 1500 | 50 | 15 |
| | SA640000 | CP4055-08 | 40 | 1000 | 500 | 10 | 40 | 1500 | 55 | 15 |
| | SA646700 | CP4060-08 | 40 | 1000 | 370 | 15 | 40 | 1500 | 60 | 15 |
| M10 insert | | | | | | | | | | |
| | SA628500 | CP4030-10 | 40 | 1000 | 700 | 8 | 25 | 750 | 30 | 10 |
| | SA630100 | CP4035-10 | 40 | 1000 | 700 | 8 | 25 | 750 | 35 | 10 |
| | SA632700 | CP4040-10 | 40 | 1000 | 500 | 10 | 30 | 1000 | 40 | 10 |
| | SA635000 | CP4045-10 | 40 | 1000 | 500 | 10 | 30 | 1000 | 45 | 15 |
| | SA638400 | CP4050-10 | 40 | 1000 | 500 | 10 | 40 | 1500 | 50 | 15 |
| | SA642600 | CP4055-10 | 40 | 1000 | 500 | 10 | 40 | 1500 | 55 | 15 |
| | SA647500 | CP4060-10 | 40 | 1000 | 370 | 15 | 40 | 1500 | 60 | 15 |
| M12 insert | | | | | | | | | | |
| | SA633500 | CP4040-12 | 40 | 1000 | 500 | 10 | 30 | 1000 | 40 | 12 |
| | SA636800 | CP4045-12 | 40 | 1000 | 500 | 10 | 30 | 1000 | 45 | 16 |
| | SA639200 | CP4050-12 | 40 | 1000 | 500 | 10 | 40 | 1500 | 50 | 16 |
| | SA645900 | CP4055-12 | 40 | 1000 | 500 | 10 | 40 | 1500 | 55 | 16 |
| | SA648300 | CP4060-12 | 40 | 1000 | 370 | 15 | 40 | 1500 | 60 | 16 |

Ultimate strength tolerance $\pm 10\%$ 1 daN = 10 N