

### TECHNICAL CHARACTERISTICS

Series of insulators designed to be used as supports or spacers of electrically active parts such as the bars used to create panels.

Made of polyester resin with the addition of glass fibres, they guarantee a high mechanical and electrical resistance over time. Furthermore, the material is non absorbing and highly self-extinguishing.

On both resting sides the insulators feature a brass or white iron zincate threaded female insert that, by means of different types of special headless screws, allows the coupling with the parts concerned, while the lower part features a hexagonal band for the fastening.

- Colour: red RAL-3002 (a different colour can be provided on request in case of large orders)
- Arc resistance: > 180 s - ASTM D-495
- Material: self-extinguishing in class V0 (1.6 mm) according to the UL-94 standard
- Operating temperature: -40 °C ÷ +130 °C
- Water absorption: < 0.2% - ASTM D-570
- Tracking resistance: 3 W/min - ASTM D-2302
- For the fastening please refer to the section "GV series accessories"



### DIMENSIONS (mm)

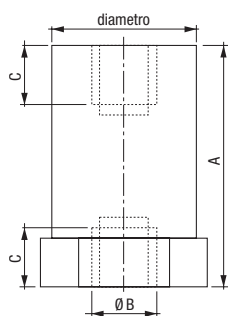

# Spacer column insulators SELECTABLE ELEMENTS

CP SERIES

|                  | Code     | Model     | Diameter (mm) | Tensile strength (daN) | Flexural strength (daN) | Max rated voltage at 50Hz for 1 min (kV) | Min internal flashover voltage AC (kV) | Operating voltage DC / AC (V) | Height (mm) |     |
|------------------|----------|-----------|---------------|------------------------|-------------------------|--|--|-------------------------------|-------------|-----|
|                  |          |           |               |                        |                         |  |  |                               | (A)         | (C) |
| <b>M4 insert</b> |          |           |               |                        |                         |  |  |                               |             |     |
|                  | SA580800 | CP2016-04 | 20            | 400                    | 250                     | 3  | 10                                     | 400                           | 16          | 5   |
|                  | SA584000 | CP2020-04 | 20            | 400                    | 250                     | 3.5                                      | 10                                     | 600                           | 20          | 5   |
|                  | SA589900 | CP2025-04 | 20            | 400                    | 200                     | 5  | 15                                     | 600                           | 25          | 5   |
| <b>M5 insert</b> |          |           |               |                        |                         |  |  |                               |             |     |
|                  | SA581600 | CP2016-05 | 20            | 400                    | 250                     | 3  | 10                                     | 400                           | 16          | 5   |
|                  | SA585700 | CP2020-05 | 20            | 400                    | 250                     | 3.5                                      | 10                                     | 600                           | 20          | 5   |
|                  | SA590700 | CP2025-05 | 20            | 400                    | 200                     | 5  | 15                                     | 600                           | 25          | 5   |
|                  | SA594900 | CP2030-05 | 20            | 400                    | 200                     | 5  | 15                                     | 600                           | 30          | 9   |
|                  | SA597200 | CP2035-05 | 20            | 400                    | 150                     | 8  | 25                                     | 600                           | 35          | 9   |
|                  | SA600400 | CP2040-05 | 20            | 400                    | 150                     | 8  | 25                                     | 600                           | 40          | 9   |
|                  | SA603800 | CP2045-05 | 20            | 400                    | 100                     | 8  | 25                                     | 600                           | 45          | 9   |
|                  | SA606100 | CP2050-05 | 20            | 400                    | 100                     | 10                                       | 30                                     | 750                           | 50          | 9   |
| <b>M6 insert</b> |          |           |               |                        |                         |  |  |                               |             |     |
|                  | SA582400 | CP2016-06 | 20            | 400                    | 250                     | 3  | 10                                     | 400                           | 16          | 5   |
|                  | SA587300 | CP2020-06 | 20            | 400                    | 250                     | 3.5                                      | 10                                     | 600                           | 20          | 5   |
|                  | SA591500 | CP2025-06 | 20            | 400                    | 200                     | 5  | 15                                     | 600                           | 25          | 5   |
|                  | SA595600 | CP2030-06 | 20            | 400                    | 200                     | 5  | 15                                     | 600                           | 30          | 10  |
|                  | SA598000 | CP2035-06 | 20            | 400                    | 150                     | 8  | 25                                     | 600                           | 35          | 10  |
|                  | SA601200 | CP2040-06 | 20            | 400                    | 150                     | 8  | 25                                     | 600                           | 40          | 10  |
|                  | SA604600 | CP2045-06 | 20            | 400                    | 100                     | 8  | 25                                     | 600                           | 45          | 10  |
|                  | SA607900 | CP2050-06 | 20            | 400                    | 100                     | 10                                       | 30                                     | 750                           | 50          | 10  |
|                  | SA609500 | CP3030-06 | 30            | 900                    | 450                     | 8  | 25                                     | 750                           | 30          | 10  |
|                  | SA611100 | CP3035-06 | 30            | 900                    | 450                     | 8  | 25                                     | 750                           | 35          | 10  |
|                  | SA613700 | CP3040-06 | 30            | 900                    | 300                     | 10                                       | 30                                     | 1000                          | 40          | 10  |
|                  | SA615200 | CP3045-06 | 30            | 900                    | 300                     | 10                                       | 30                                     | 1000                          | 45          | 10  |
|                  | SA617800 | CP3050-06 | 30            | 900                    | 200                     | 10                                       | 40                                     | 1500                          | 50          | 15  |
|                  | SA619400 | CP3055-06 | 30            | 900                    | 200                     | 10                                       | 40                                     | 1500                          | 55          | 15  |
|                  | SA621000 | CP3060-06 | 30            | 900                    | 150                     | 15                                       | 40                                     | 1500                          | 60          | 15  |
|                  | SA623600 | CP3065-06 | 30            | 900                    | 150                     | 15                                       | 40                                     | 1500                          | 65          | 15  |
|                  | SA625100 | CP3070-06 | 30            | 900                    | 150                     | 15                                       | 40                                     | 1500                          | 70          | 15  |

Ultimate strength tolerance ±10% 1 daN = 10 N

|                   | Code     | Model     | Diameter (mm) | Tensile strength (daN) | Flexural strength (daN) | Max rated voltage at 50Hz for 1 min (kV) | Min internal flashover voltage AC (kV) | Operating voltage DC / AC (V) | Height (mm) |     |
|-------------------|----------|-----------|---------------|------------------------|-------------------------|--|--|-------------------------------|-------------|-----|
|                   |          |           |               |                        |                         |  |  |                               | (A)         | (C) |
| <b>M8 insert</b>  |          |           |               |                        |                         |  |  |                               |             |     |
|                   | SA583200 | CP2016-08 | 20            | 400                    | 250                     | 3  | 10                                     | 400                           | 16          | 5   |
|                   | SA588100 | CP2020-08 | 20            | 400                    | 250                     | 3.5                                      | 10                                     | 600                           | 20          | 5   |
|                   | SA592300 | CP2025-08 | 20            | 400                    | 200                     | 5  | 15                                     | 600                           | 25          | 5   |
|                   | SA596400 | CP2030-08 | 20            | 400                    | 200                     | 5  | 15                                     | 600                           | 30          | 10  |
|                   | SA599800 | CP2035-08 | 20            | 400                    | 150                     | 8  | 25                                     | 600                           | 35          | 10  |
|                   | SA602000 | CP2040-08 | 20            | 400                    | 150                     | 8  | 25                                     | 600                           | 40          | 10  |
|                   | SA605300 | CP2045-08 | 20            | 400                    | 100                     | 8  | 25                                     | 600                           | 45          | 10  |
|                   | SA608700 | CP2050-08 | 20            | 400                    | 100                     | 10                                       | 30                                     | 750                           | 50          | 10  |
|                   | SA610300 | CP3030-08 | 30            | 900                    | 450                     | 8  | 25                                     | 750                           | 30          | 10  |
|                   | SA612900 | CP3035-08 | 30            | 900                    | 450                     | 8  | 25                                     | 750                           | 35          | 10  |
|                   | SA614500 | CP3040-08 | 30            | 900                    | 300                     | 10                                       | 30                                     | 1000                          | 40          | 10  |
|                   | SA616000 | CP3045-08 | 30            | 900                    | 300                     | 10                                       | 30                                     | 1000                          | 45          | 15  |
|                   | SA618600 | CP3050-08 | 30            | 900                    | 200                     | 10                                       | 40                                     | 1500                          | 50          | 15  |
|                   | SA620200 | CP3055-08 | 30            | 900                    | 200                     | 10                                       | 40                                     | 1500                          | 55          | 15  |
|                   | SA622800 | CP3060-08 | 30            | 900                    | 150                     | 15                                       | 40                                     | 1500                          | 60          | 15  |
|                   | SA624400 | CP3065-08 | 30            | 900                    | 150                     | 15                                       | 40                                     | 1500                          | 65          | 15  |
|                   | SA626900 | CP3070-08 | 30            | 900                    | 150                     | 15                                       | 40                                     | 1500                          | 70          | 15  |
|                   | SA627700 | CP4030-08 | 40            | 1000                   | 700                     | 8  | 25                                     | 750                           | 30          | 10  |
|                   | SA629300 | CP4035-08 | 40            | 1000                   | 700                     | 8  | 25                                     | 750                           | 35          | 10  |
|                   | SA631900 | CP4040-08 | 40            | 1000                   | 500                     | 10                                       | 30                                     | 1000                          | 40          | 10  |
|                   | SA634300 | CP4045-08 | 40            | 1000                   | 500                     | 10                                       | 30                                     | 1000                          | 45          | 15  |
|                   | SA637600 | CP4050-08 | 40            | 1000                   | 500                     | 10                                       | 40                                     | 1500                          | 50          | 15  |
|                   | SA640000 | CP4055-08 | 40            | 1000                   | 500                     | 10                                       | 40                                     | 1500                          | 55          | 15  |
|                   | SA646700 | CP4060-08 | 40            | 1000                   | 370                     | 15                                       | 40                                     | 1500                          | 60          | 15  |
| <b>M10 insert</b> |          |           |               |                        |                         |  |  |                               |             |     |
|                   | SA628500 | CP4030-10 | 40            | 1000                   | 700                     | 8  | 25                                     | 750                           | 30          | 10  |
|                   | SA630100 | CP4035-10 | 40            | 1000                   | 700                     | 8  | 25                                     | 750                           | 35          | 10  |
|                   | SA632700 | CP4040-10 | 40            | 1000                   | 500                     | 10                                       | 30                                     | 1000                          | 40          | 10  |
|                   | SA635000 | CP4045-10 | 40            | 1000                   | 500                     | 10                                       | 30                                     | 1000                          | 45          | 15  |
|                   | SA638400 | CP4050-10 | 40            | 1000                   | 500                     | 10                                       | 40                                     | 1500                          | 50          | 15  |
|                   | SA642600 | CP4055-10 | 40            | 1000                   | 500                     | 10                                       | 40                                     | 1500                          | 55          | 15  |
|                   | SA647500 | CP4060-10 | 40            | 1000                   | 370                     | 15                                       | 40                                     | 1500                          | 60          | 15  |
| <b>M12 insert</b> |          |           |               |                        |                         |  |  |                               |             |     |
|                   | SA633500 | CP4040-12 | 40            | 1000                   | 500                     | 10                                       | 30                                     | 1000                          | 40          | 12  |
|                   | SA636800 | CP4045-12 | 40            | 1000                   | 500                     | 10                                       | 30                                     | 1000                          | 45          | 16  |
|                   | SA639200 | CP4050-12 | 40            | 1000                   | 500                     | 10                                       | 40                                     | 1500                          | 50          | 16  |
|                   | SA645900 | CP4055-12 | 40            | 1000                   | 500                     | 10                                       | 40                                     | 1500                          | 55          | 16  |
|                   | SA648300 | CP4060-12 | 40            | 1000                   | 370                     | 15                                       | 40                                     | 1500                          | 60          | 16  |

Ultimate strength tolerance ±10% 1 daN = 10 N