

# Movement detectors

# SENS IR

# DIMENSIONS (mm)

# CONNECTION DIAGRAM

Twilight movement detector that captures the movements that occur within the sensor's action field and, if necessary, activates a load such as the lighting system.  
The regulators on the front allow you to set the timing and brightness threshold below which the load is activated.  
Sens IR is small and compact to be installed with discretion in the flush-mounting boxes of any room and is supplied with adapters that allow installation with the plates of the main civil series.



- 1 Installation in flush-mounting boxes with a height of 45 mm
- 2 Twilight sensor for environmental brightness measurement
- 3 Movement sensor
- 4 Timing regulator (from 30 seconds to 15 minutes)
- 5 Intervention brightness regulator (from 5 to 100 lux)

## Front view

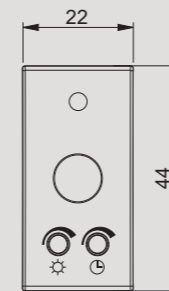

## Side view

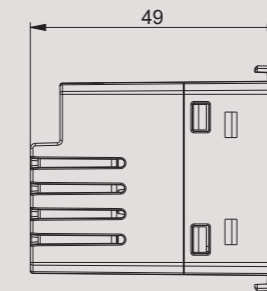

## Diagram

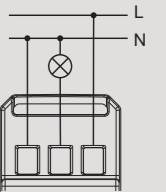

All trademarks in the document are registered by their rightful owners.

# COMPLEMENTS FOR CIVIL SERIES

## TECHNICAL INFORMATION

## MOVEMENT DETECTORS

- Timing regulator: sets how long the load must remain on
- Brightness regulator: sets the brightness level below which to activate the load in the case of movement detector
- Relay normally open with "zero crossing" technology to increase the duration of contacts and better electrical performance
- Compact size: only 1 module occupied in the flush-mounting box
- Adapters that allow adaptability with the main civil series (see "Adaptable plates") included in the package

### Adaptable plates

ABB Mylos series	Bticino LivingLight Air series
Ave S44 series	Bticino Matix series
Bticino Axolute series	Gewiss Chorus series
Bticino Axolute Air series	Vimar Arké series
Bticino Light series	Vimar Eikon series
Bticino Living International series	Vimar Eikon Evo series
Bticino LivingLight series (LL)	Vimar Plana series

For information on the possibility of using different plates contact the technical assistance service

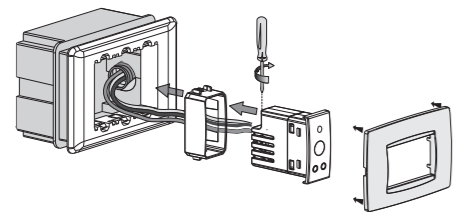

Code	Model	Description	Color	Power supply
VE770700	Sens IR Grigio	Movement detector with twilight sensor compact size	Grey	230 Vac
VE770800	Sens IR Bianco	Movement detector with twilight sensor compact size	White	230 Vac
VE765200	Sens IR Argento	Movement detector with twilight sensor compact size	Silver Tech	230 Vac

## GENERAL CHARACTERISTICS

Power supply	Vac	230 (-10% ÷ +10%)
Frequency	Hz	50/60
Maximum absorption	VA (W)	5 (1)
Mounting		flush
Maximum cables section	mm <sup>2</sup>	1.5
Output		1 relay normally open
Range of relay contacts at 250 Vac	A	5 (on resistive load)
Intervention time		30 seconds ÷ 15 minutes
Intervention field	lux	5 ÷ 100
Detection angle		110° at 20 °C
Detection range		7 meters at 20 °C
Operating temperature	°C	0 ÷ 35
Storage temperature	°C	-10 ÷ 60
Operating humidity	RH	20% ÷ 90% non condensing
Protection degree		IP40 (on the front)

### CONNECTABLE LOADS

Incandescent		800 W
Fluorescent (neon)		400 VA
Halogen		800 W
Low consumption (CFL)		100 W
Led		50 W

## REFERENCE STANDARDS

Compliance with the Community Directives: 2014/35/EU (LVD) and 2014/30/EU (EMCD) is declared in reference to the following harmonized standards: • EN 60669-2-1