

# Accessories for twilight switches

## SIL

### EXTERNAL LUMINOSITY PROBE

- Fastened to wall
- Usable with CR1DIN, Memo AST Lux, Cronolux
- Degree of protection: IP65
- Operating temperature:  $-20^{\circ}\text{C} \div +50^{\circ}\text{C}$
- Max distance between probe and device: about 50 m
- Insulated in double insulation



Code	Model	Description
VJ62301111	SIL	External probe of intense luminosity for CR1DIN and Cronolux
VE765700	SIL	External probe of intense luminosity for CR1DIN and Memo AST LUX

## DIMENSIONS (mm)

### Front view

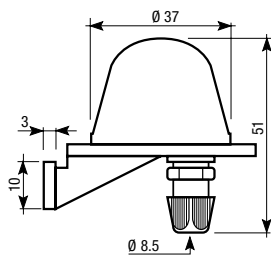

### Side view

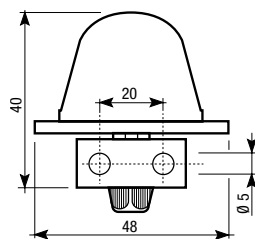

## SIL-AV

### ANTI-VANDAL LUMINOSITY EXTERNAL PROBE

- Self-locking graft mounting
- Usable with CR1DIN, Memo AST Lux, Cronolux
- Degree of protection: IP65
- Operating temperature:  $-20^{\circ}\text{C} \div +50^{\circ}\text{C}$
- Max. distance between probe and device: about 50 m



Code	Model	Description
VE380200	SIL-AV	External probe of intense luminosity for CR1DIN and Cronolux
VE765800	SIL-AV	External probe of intense luminosity for CR1DIN and Memo AST LUX

## DIMENSIONS (mm)

