

Current transformers

TU3b

Series of wound primary amperometric transformers for instruments in alternating current, ratio transformation x/5 A and panel mounting.

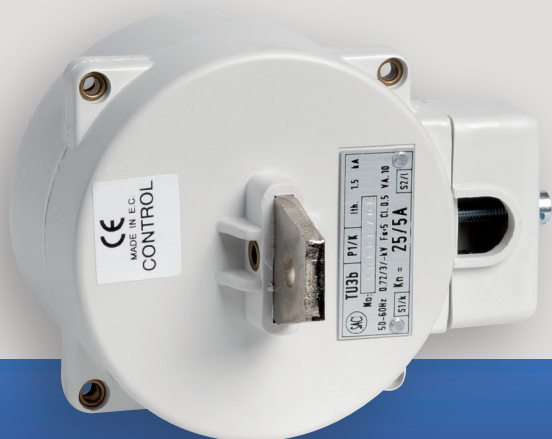

WOUND PRIMARY

GENERAL CHARACTERISTICS

| | | | |
|-------------------------|--------|------------|----------|
| Test voltage (1 min) | kV | 3 | |
| Frequency | Hz | 50 / 60 | |
| Safety factor | FS | <5 | |
| Case | | insulated | |
| Max rated voltage | V | 720 | |
| Max continuous overload | A | 1.2 In | |
| Class | | 0.5 | 1 |
| Nominal power VA | 10/5 A | 10 | 20 |
| | 15/5 A | 10 | - |
| | 25/5 A | 10 | 20 |

DIMENSIONS (mm)

Front view

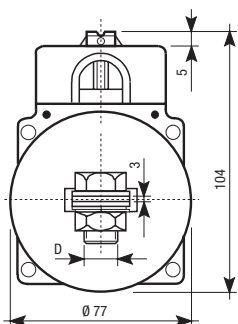

Side view

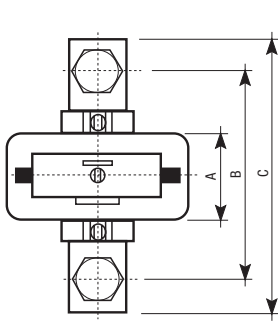

| | A | B | C | D |
|-------------|------------|----|----|---------|
| Tu3b | 5/5 ÷ 25/5 | 52 | 92 | 112 M.6 |

CONNECTION DIAGRAM

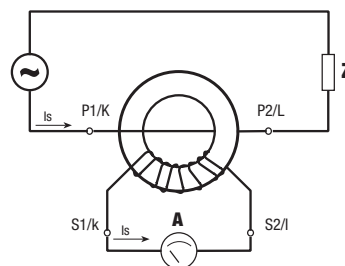

When connecting the amperometric transformers it is important to respect the directions of the current.
 Primary: from P1/K to P2/L
 Secondary: from S1/k to S2/l

Notes: the capacity of the amperometric transformer must correspond to the full scale of the instrument.

| Code | Model | Description | Capacity |
|-------------------|-------|---|----------|
| VJ31462005 | TU3b | Wound primary current transformer (20 VA) | 10/5 A |
| VJ31532305 | TU3b | Wound primary current transformer (20 VA) | 25/5 A |
| VJ31792005 | TU3b | Wound primary current transformer (10 VA) | 10/5 A |
| VJ31792105 | TU3b | Wound primary current transformer (10 VA) | 15/5 A |
| VJ31872305 | TU3b | Wound primary current transformer (10 VA) | 25/5 A |